

ZLKL, s. r. o.

Company presentation

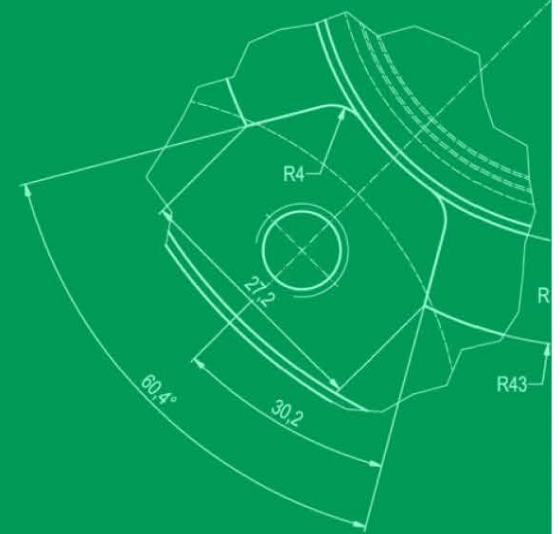

www.zlkl.cz

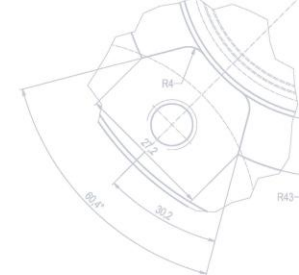
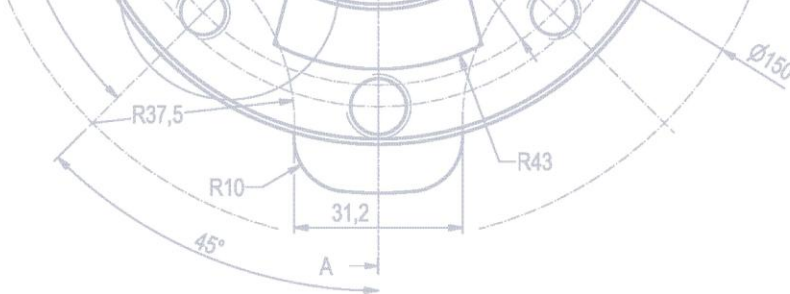

BASIC FACTS

Basic figures

- Legal form: s.r.o. (equal to GmbH)
- Established: 1993
- Number of employees: 330
- Annual turnover: 50 Million €

Core business

- Division Merger – Forming
 - Stamping, laser cutting, bending, welding, powder painting
- Division Auto
 - High-volume machining, fine cleaning
 - Focus on automation
- Division Merger – Machining
 - Low & medium-volume machining



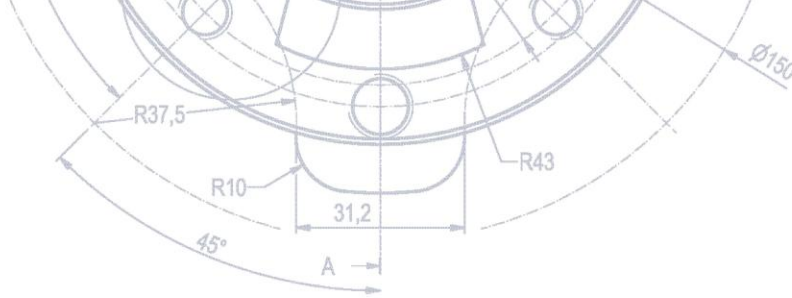

www.zlkl.cz

CERTIFICATION

CERTIFICATE

Certification Body for certification of management systems No. 3300
accredited by ČIA according to ČSN EN ISO/IEC 17021-1:2016

CERT QUALITY SYSTEM s.r.o.
confirms that the company
ZLKL, s. r. o.
Moravičanská 581/29
CZ - 789 83 Loštice

for fields of activities:
**Machining
Forming
Welding
Powder Coating
Machined and Formed Parts Reaserch
and Development
Fine cleaning**

has established and applies an Quality Management Systems in accordance with the standard
ČSN EN ISO 9001:2016

Certificate Validity: 19.05.2028
Certificate Number: Q20250506

20.05.2025
Date of the certificate issue

CERTIFIKACNÍ ORGANIZACE
CERT QUALITY SYSTEM s.r.o.
Head of Certification Body
CERT QUALITY SYSTEM s.r.o.

CERTIFICATE

Certification Body for certification of management systems No. 3300
accredited by ČIA according to ČSN EN ISO/IEC 17021-1:2016

CERT QUALITY SYSTEM s.r.o.
confirms that the company
ZLKL, s. r. o.
Moravičanská 581/29
CZ - 789 83 Loštice

for fields of activities:
**Machining
Forming
Welding
Powder Coating
Machined and Formed Parts Reaserch
and Development
Fine cleaning**

has established and applies an Environmental Management Systems in accordance with the standard
ČSN EN ISO 14001:2016

Certificate Validity: 19.05.2028
Certificate Number: E20250506

20.05.2025
Date of the certificate issue

CERTIFIKACNÍ ORGANIZACE
CERT QUALITY SYSTEM s.r.o.
Head of Certification Body
CERT QUALITY SYSTEM s.r.o.

CERTIFICATE

Certification Body for certification of management systems No. 3300
accredited by ČIA according to ČSN EN ISO/IEC 17021-1:2016

CERT QUALITY SYSTEM s.r.o.
confirms that the company
ZLKL, s. r. o.
Moravičanská 581/29
CZ - 789 83 Loštice

for fields of activities:
**Machining
Forming
Welding
Powder Coating
Machined and Formed Parts Reaserch
and Development
Fine cleaning**

has established and applies a Occupational health and safety management systems in accordance with the standard
ČSN ISO 45001:2018

Certificate Validity: 19.05.2028
Certificate Number: S20250506

20.05.2025
Date of the certificate issue

CERTIFIKACNÍ ORGANIZACE
CERT QUALITY SYSTEM s.r.o.
Head of Certification Body
CERT QUALITY SYSTEM s.r.o.

Bureau Veritas Certification

Certificate of Approval
AWARDED TO
ZLKL, s. r. o.
Moravičanská 581/29, 789 83, Loštice, Czech Republic
IATF 16949

Bureau Veritas Certification certifies that the Quality Management System of the above organization has been audited and found to be in accordance with the requirements of
IATF 16949 - FIRST EDITION
and the applicable customer specific requirements

SCOPE
Manufacturing
PERMITTED EXCLUSIONS
3.3 - Design and development of products and services
PRODUCTS DELIVERED
Machined parts and Fine cleaning products

Date Of Certification: 06-08-2024
Date Of Expiration: 09-08-2027
IATF Certificate #: 0516120
Bureau Veritas Certification Certificate No: C2012616 - IATF

Revision: 2

For Bureau Veritas Certification Holding, Tour 30/31, 4 place des Corbeaux, 92400 COURMAYEUR - FRANCE
(The official document is in English, any translations of this document shall be used for reference only.)

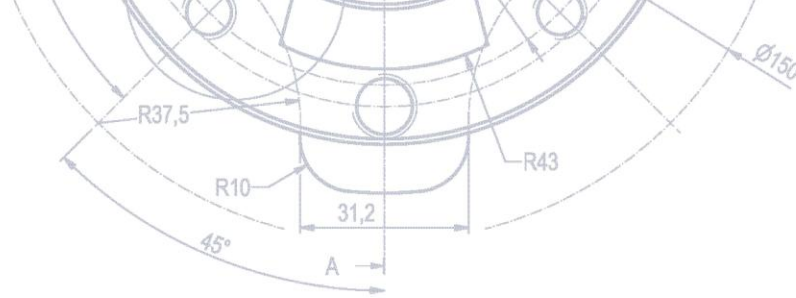

www.zlkl.cz

QMS & OUR BEHAVIOUR

Quality Management System

- ISO 9001:2016
- ISO 14001:2016
- ISO 45001:2018
- IATF 16949
- Common in using VDA standards

Our behaviour

- Focus on **Project management**
- Focus on **Customer Support** and **Cost Saving** solutions in the pre-design phase
- **Lean methods** use in production

Measuring Equipment

- 3D measuring laboratories - Zeiss Machines
- 3D Scanner ATOS 5
- 2D Keyence microscope
- 2D optical measuring – VICI Vision
- Various measuring devices & standard gauges
- CAQ (Palstat) – FMEA, Control Plan, SPC, MSA

Customer's VDA 6.3 audits

- Bosch Rexroth
- Daikin
- Daimler AG
- Siemens
- ABB
- NIDEC corp.
- Erdrich Umformtechnik GmbH

Division Merger - Forming

Senior manager: Ivo Nemrava

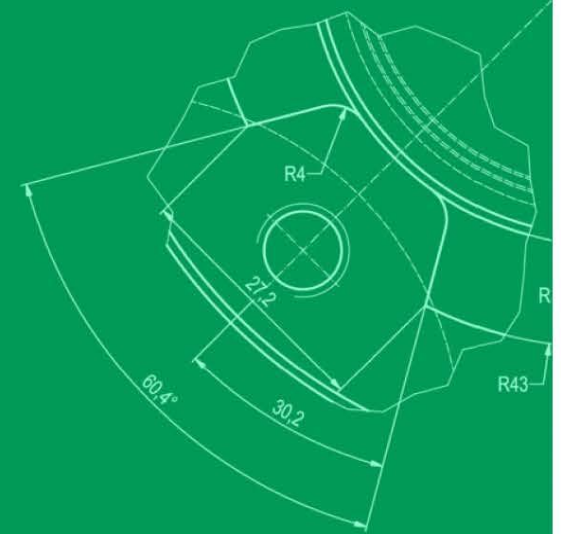

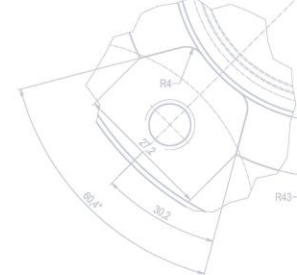
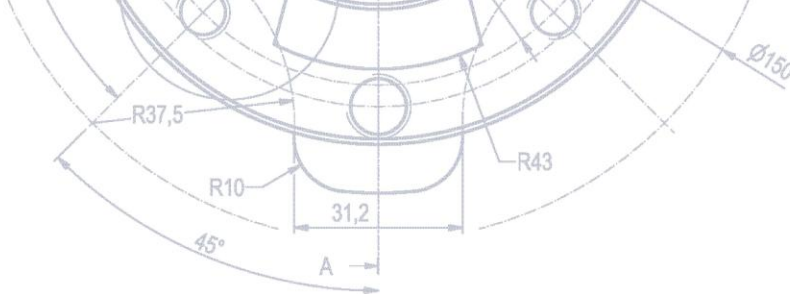

www.zlkl.cz

BASIC FACTS

Core business

- Stamping, laser cutting, bending, welding, powder painting

Certificates

- ISO 9001, ISO 14001, ISO 45001



Our strategic suppliers of technology:

SCHULER



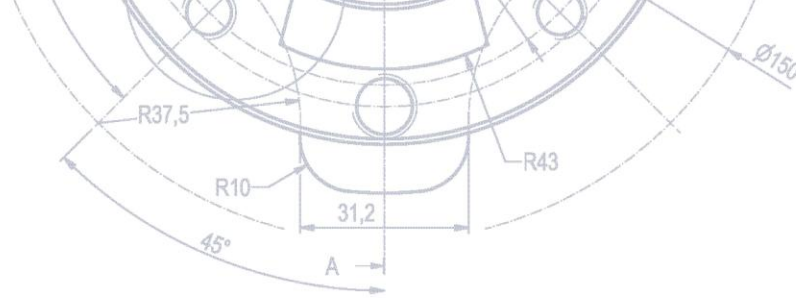

www.zlkl.cz

INTRODUCTION

Services

- Technology process design
- Prototypes production, process optimisation
- Mass production
- Forming, welding, surface treatment

Technology

- Eccentric and hydraulic presses from 10t - 250t with progressive tooling
- CNC cutting-punching, CNC laser, CNC bending, roll bending, wire narrowing
- Manual and automatized welding cells
- Powder painting

Materials & Products

- Steel, copper, aluminium, stainless steel, brass
- Electrical industry
- Industrial automation
- Automotive industry
- ATEX environment parts

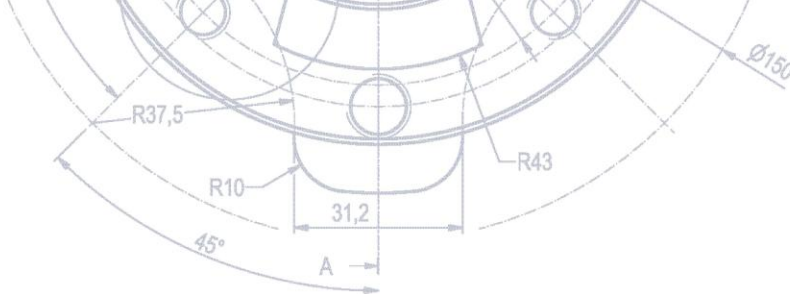

CNC PUNCHING

Trumpf – 11 CNC machines

- **TruPunch 3000** 1 machine
- **TruPunch 5000** 9 machines
 - Connected to an automatic material warehousing system
 - Equipped with an automatic tool-loading system
- **TruMatic 7000** 1 machine
 - Combination of laser and punching tools



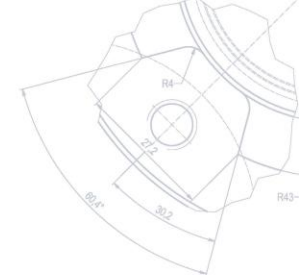
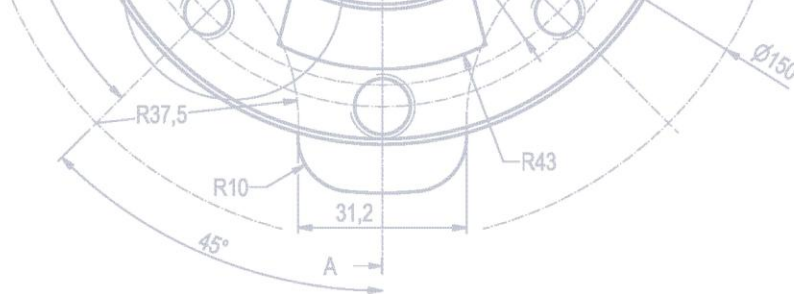

CNC BENDING

Trumpf – 13 CNC machines

- TruBend 7036 1 machine
- TruBend 7050 2 machines
- TruBend 5130 4 machines
- TruBend 5170 2 machines
- TruBend Cell 7000 1 machine
- TruBend Cell 5000 3 machines

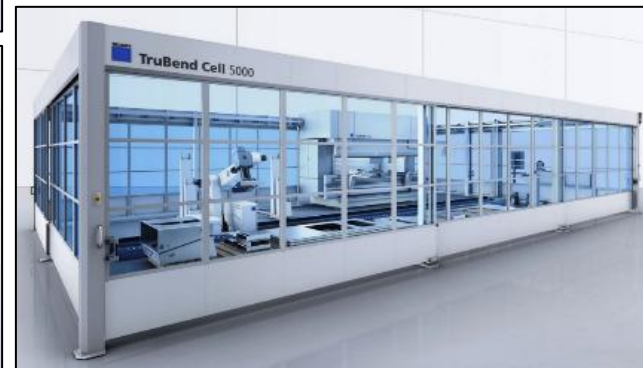
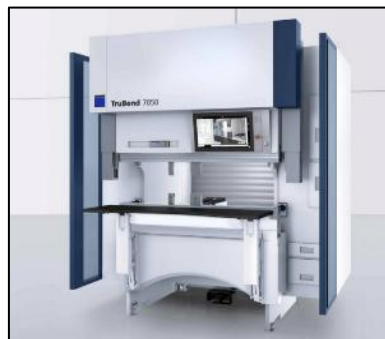

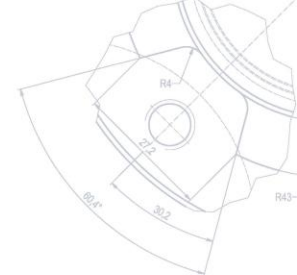
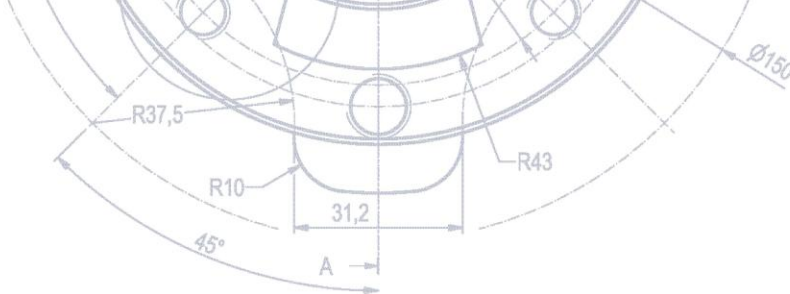

www.zlkl.cz

CNC LASER CUTTING

Trumpf – 4 CNC machines

- TruLaser 3030 1 machine 3kW
- TruLaser 5030 3 machines 6kW, 2x8kW



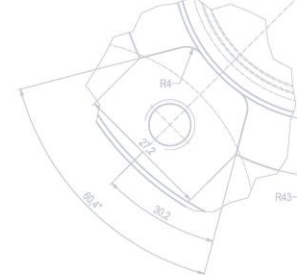
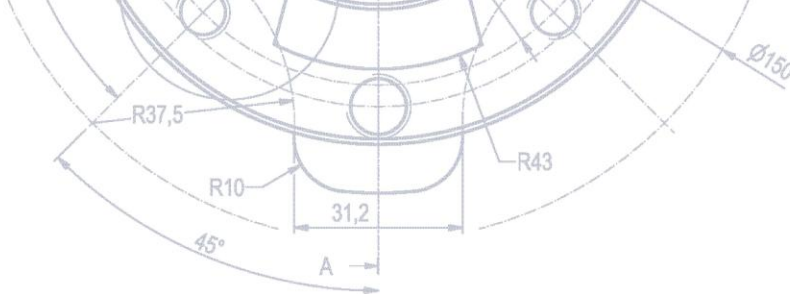

www.zlkl.cz

SELF CLINCHING

Semi-automatic PEM machines



TOX clinching connection

Semi-automatic PEM machines

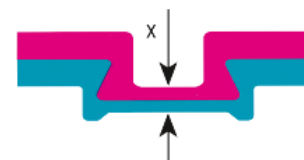

TOX®

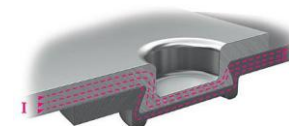

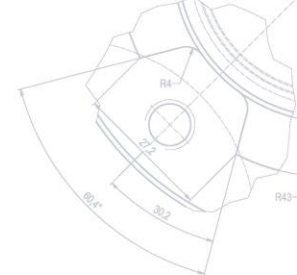
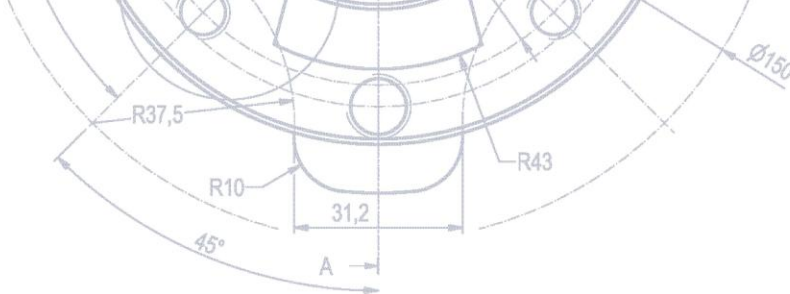

www.zlkl.cz

COIL WIRE NARROWING & PRECISE CUTTING



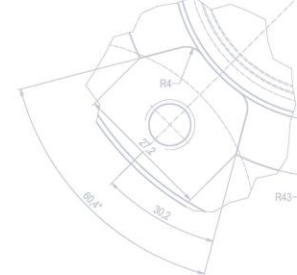
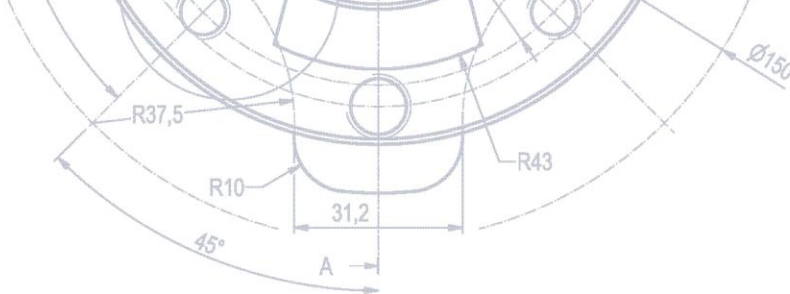

www.zlkl.cz

CNC DEBBURING & GRINDING

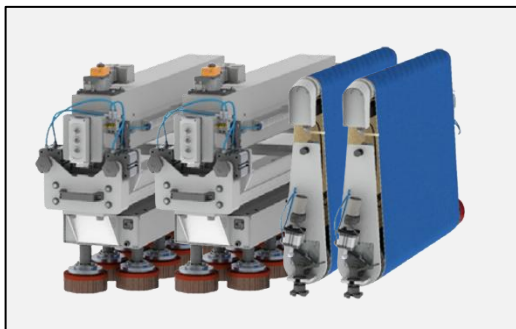

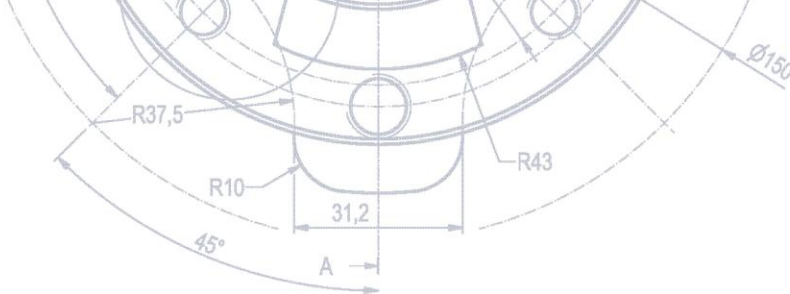

www.zlkl.cz

ROLL BENDING

Faccin machine

- 2 machines for variable diameters
 - 1 robot-operated cell



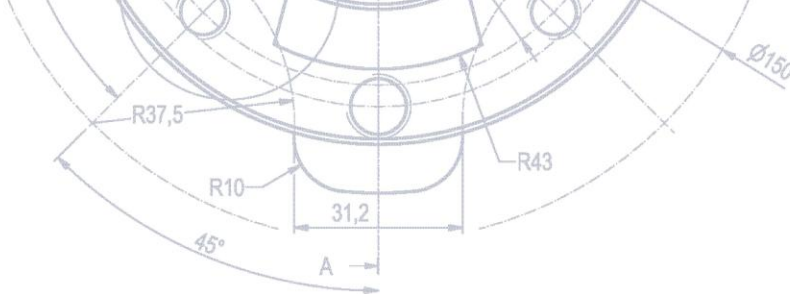

www.zlkl.cz

WELDING

Certification ISO 3834-2:22

- Achieved in 1Q 2025
- Internal IWS

Welding methods

- MIG/MAG, TIG, CMT
- Spot Welding
- CNC Laser Welding – Tru Laser Cell 3000
 - Up to size 500 x 500 x 500 mm
- Soldering

Materials

- Aluminium, steel, stainless steel, copper



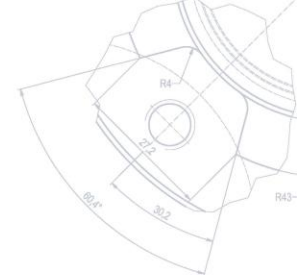
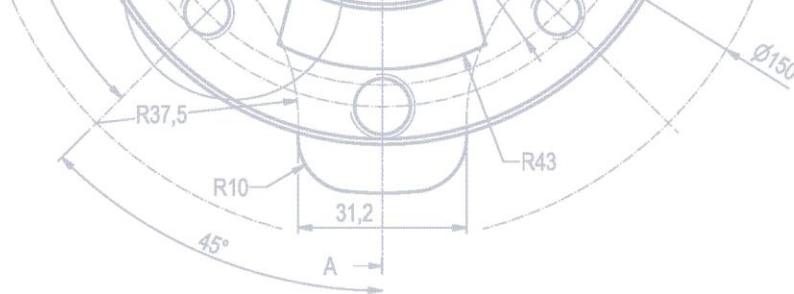

PROGRESSIVE TOOLINGS

Hydraulic presses

- From 10t - 250t

Latest press shop investments

- Eccentric presses
 - 2x Schuler CFL160
 - Schuler CFL250



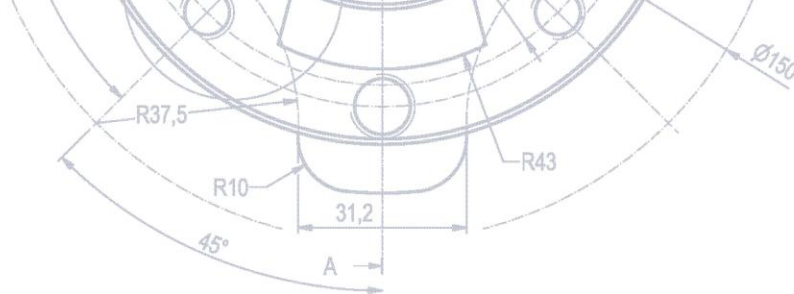

www.zlkl.cz

CUSTOMER TOOLS STOCK

Internal tool shop

- Maintenance, sharpening, slight adjustments



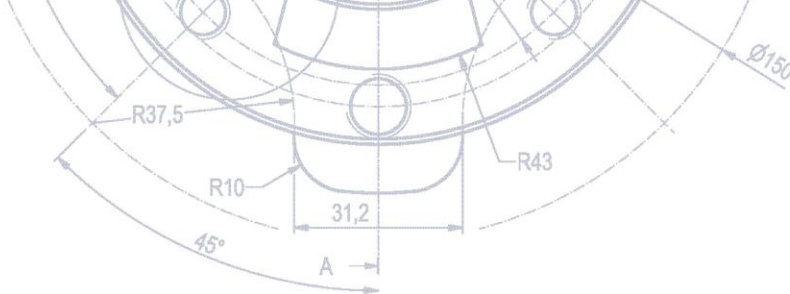

www.zlkl.cz

PRODUCTS EXAMPLES - PROJECTS

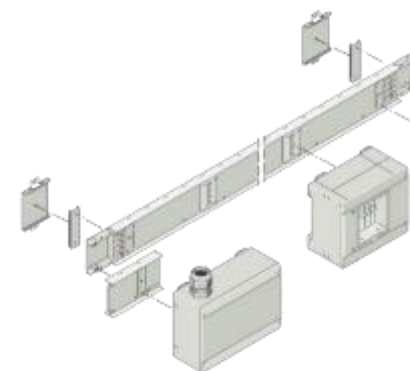

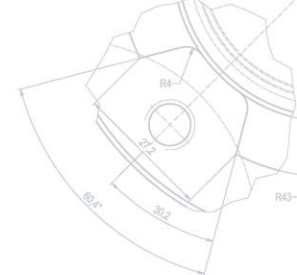
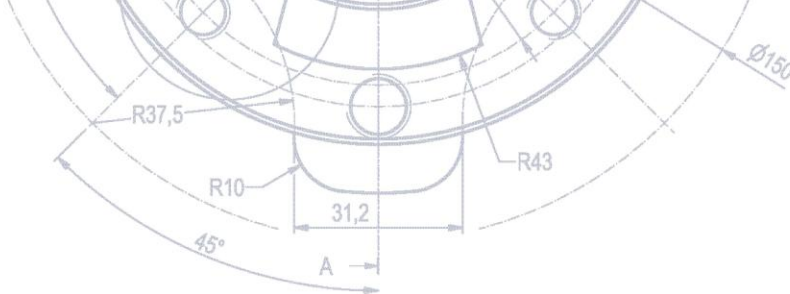

www.zlkl.cz

PRODUCTS EXAMPLES

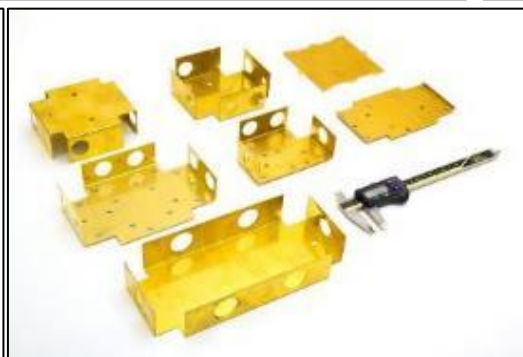

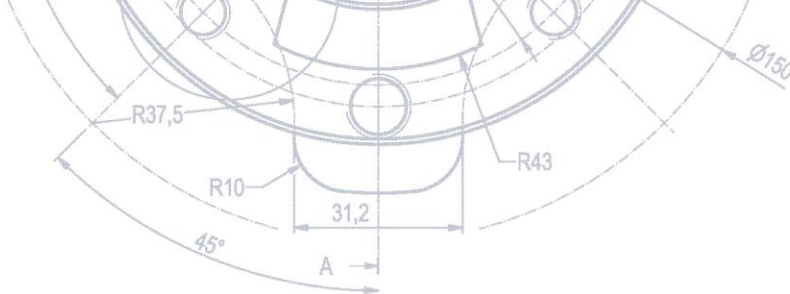

www.zlkl.cz

PRODUCTS EXAMPLES – WELDED PARTS

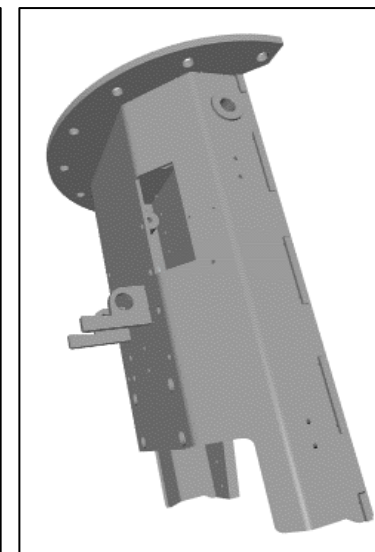
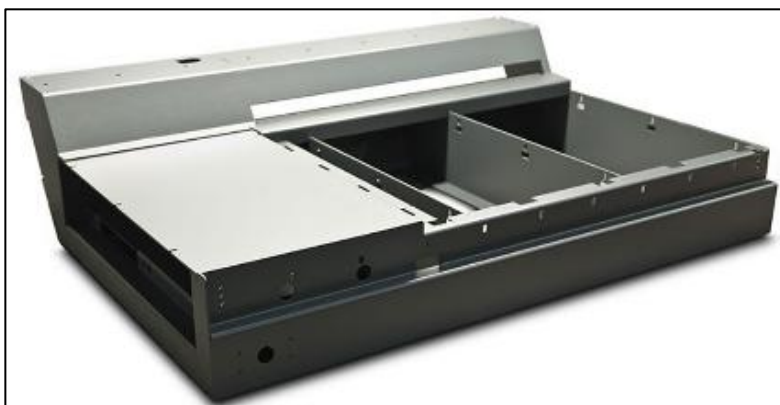

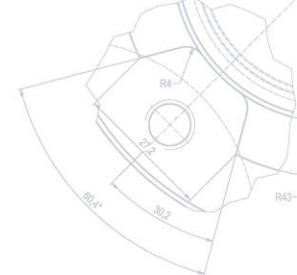
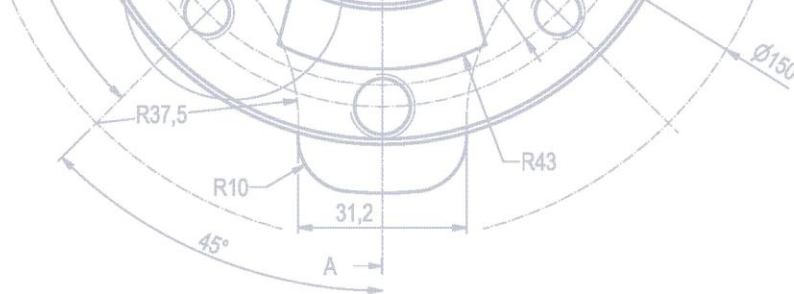

www.zlkl.cz

PRODUCTS EXAMPLES - ASSEMBLIES

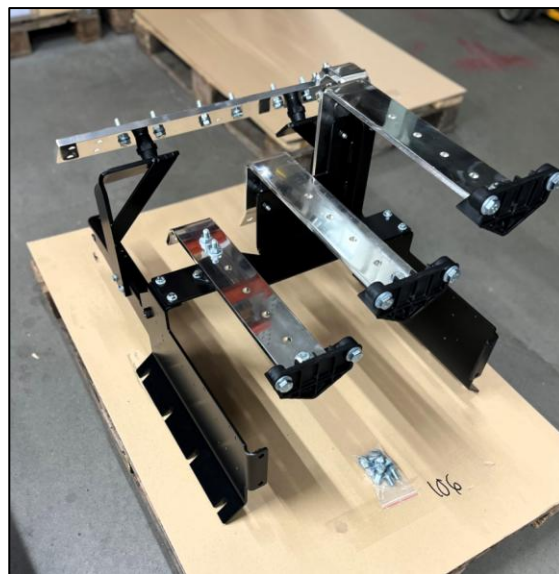

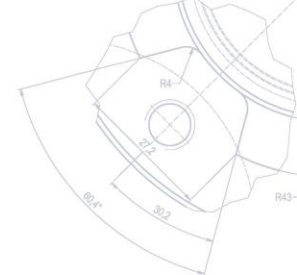
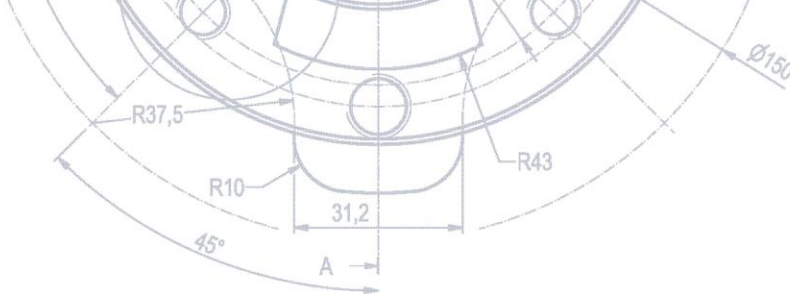

POWDER PAINTING LINE 1

- Castings, thick-walled materials
 - Robot operated



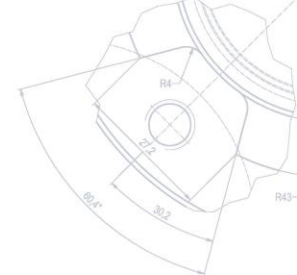
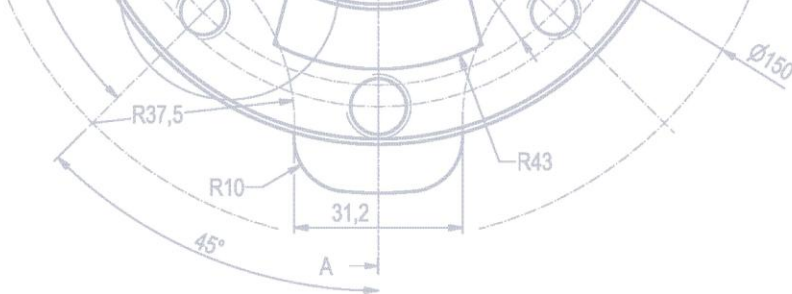

POWDER PAINTING LINE 2

- Metal sheet parts, thin-walled materials
 - Robot operated
 - High speed of processing, big capacity

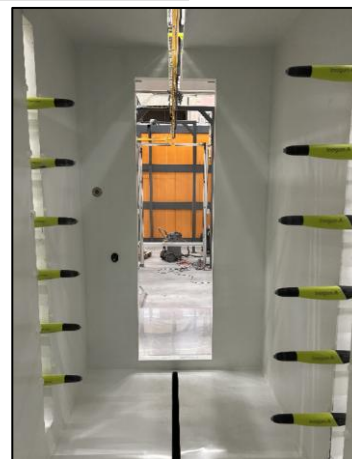
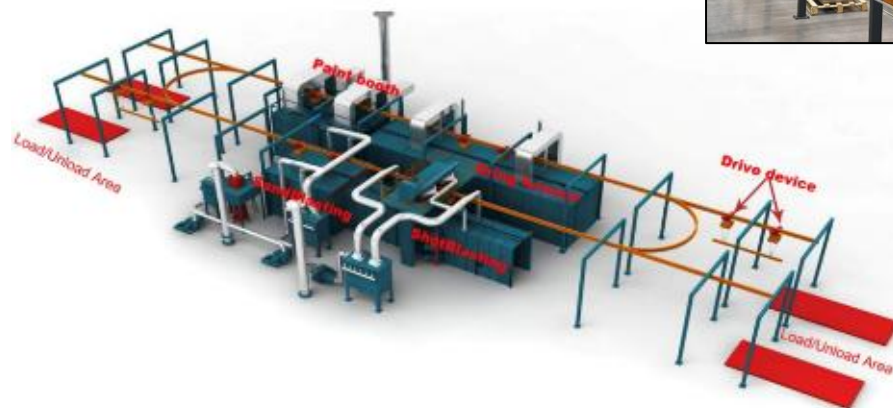
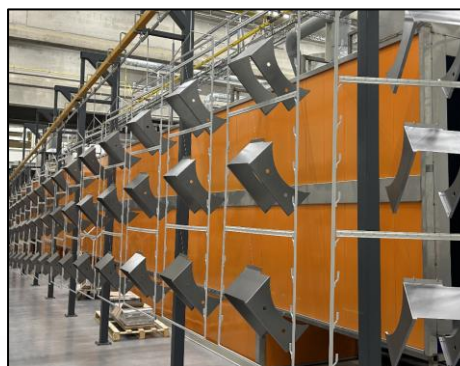

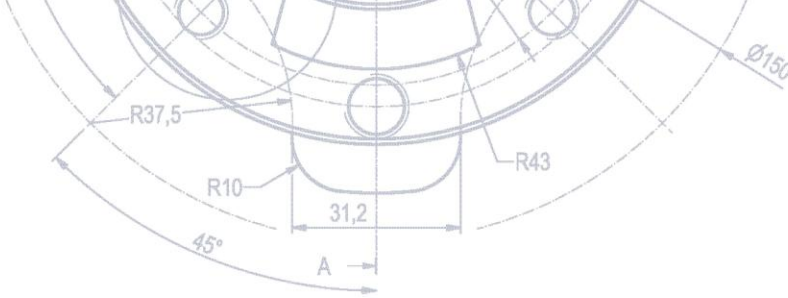

www.zlkl.cz

INVESTMENTS

TRUMPF



Trumpf

- One machine TruLaser 5030
 - Power of 10 kW
- Three machines TruPunch 5000
 - With Sheet master included
- Two machines TruBend Cell 5000
 - Fully automatized bending cell
- TruLaser Weld 5000
 - Size up to 1500 x 1500 x 1500 mm

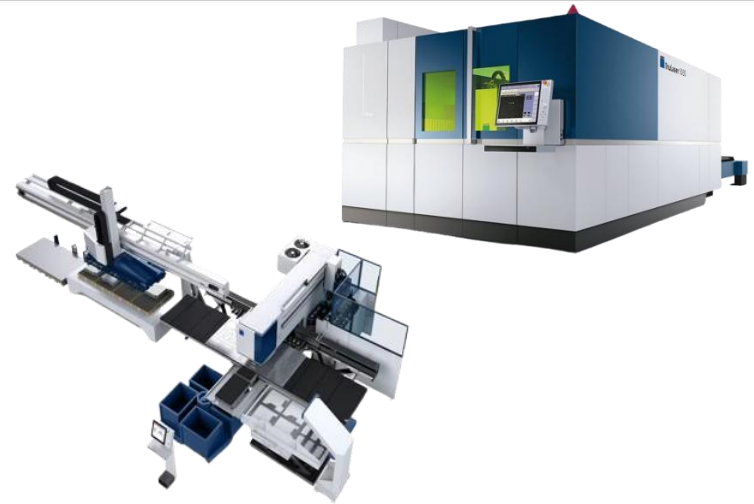

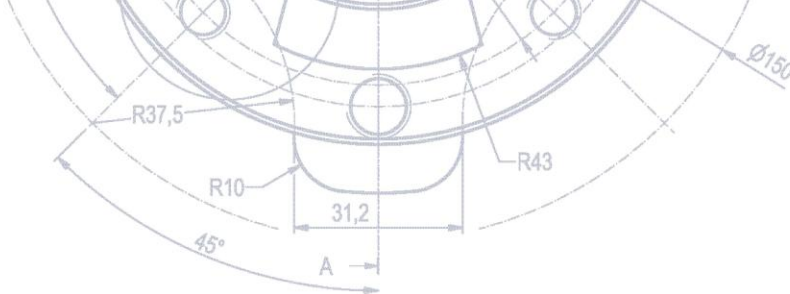

INVESTMENTS

Hydraulic press

- SCHULER 630t Servo Press (February 2027)



Roll forming

- Profiling line - CNC roll-forming machines for ultra-flexible profile production



CNC BUS-BAR technology

- VaskiPUNCH Inspiration LINE
 - VaskiPUNCH Inspiration
 - VaskiGRIND
 - VaskiSHAPE Inspiration 3 axis
 - VaskiBEND Inspiration



New production hall available by the end of 2025

- New 8000 m²
- Finalizing stage ongoing
- To be ready by November 2025
- Logistics, storing, production

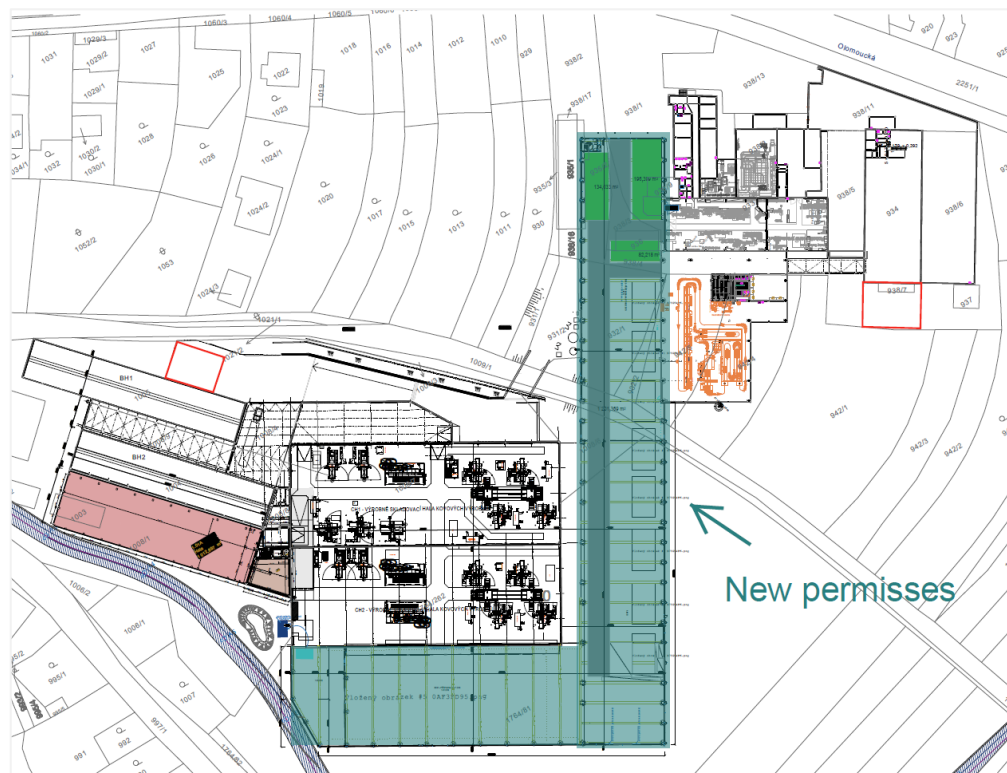

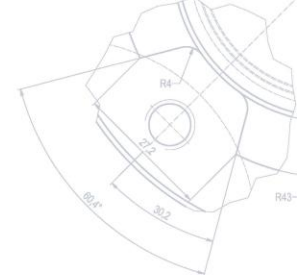
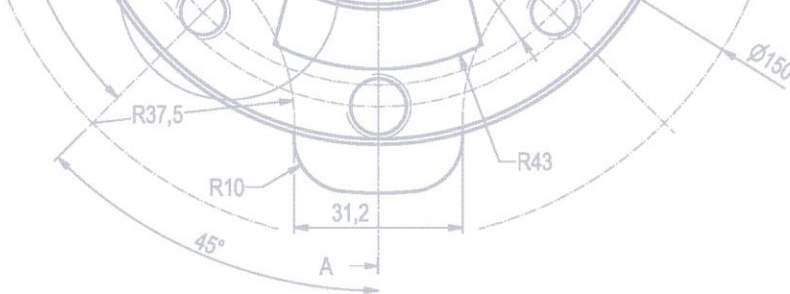

www.zlkl.cz

New production hall available by the end of 2025

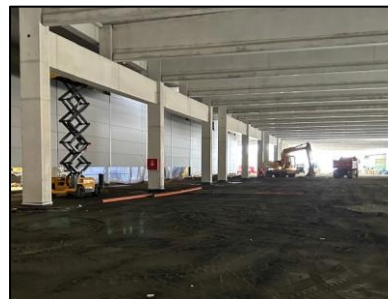

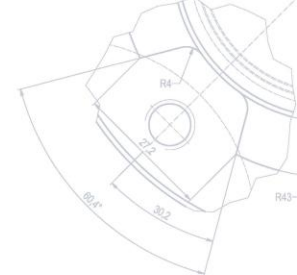
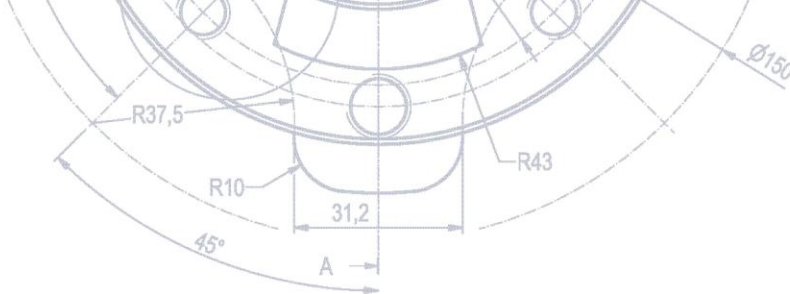

www.zkl.cz

CUSTOMERS

SIEMENS

DAIKIN

Ljunghäll
GNUTTI CARLO GROUP

Nidec
All for dreams

ABB

EMERSON

Itron

Miele

BANG & OLUFSEN

TYMPHANY

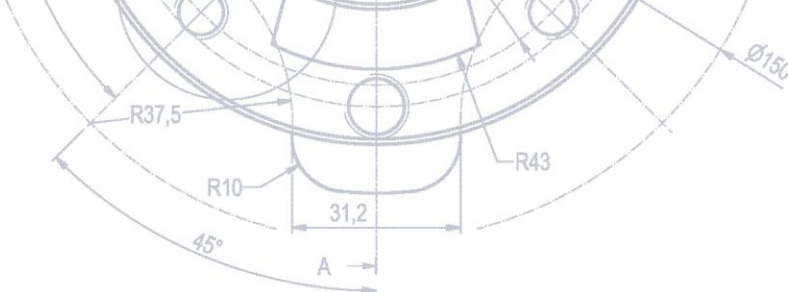

www.zlkl.cz

SHOPFLOOR TOUR

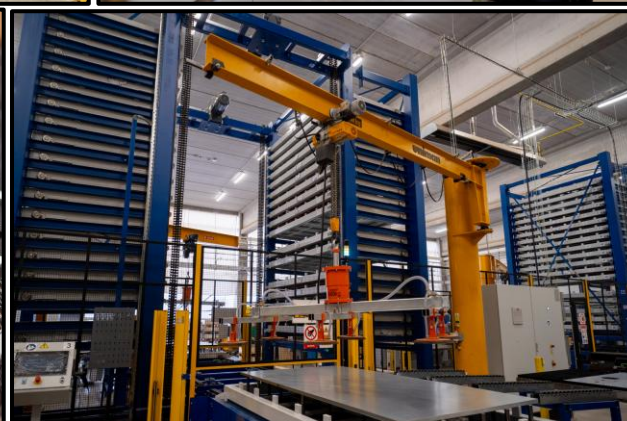
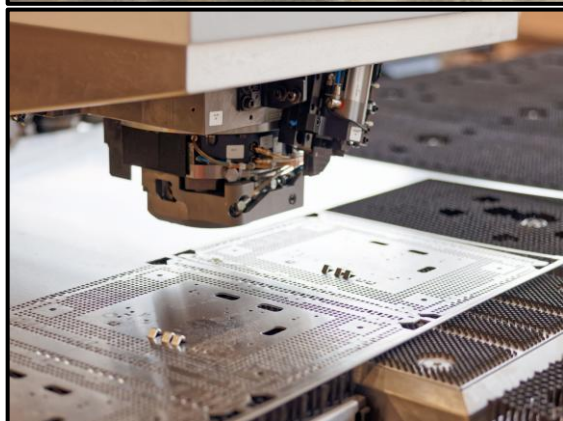
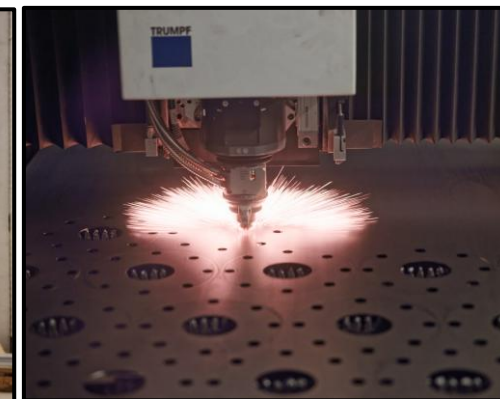

Division Merger - Machining

Leaders: František Hrdlička & Ivo Nemrava

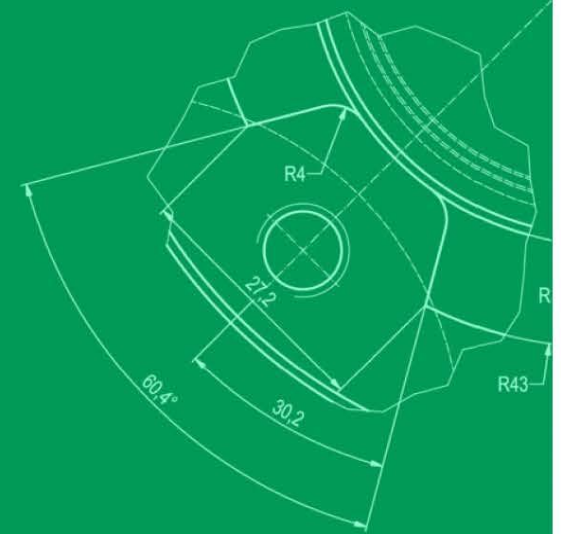

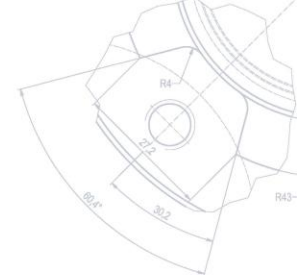
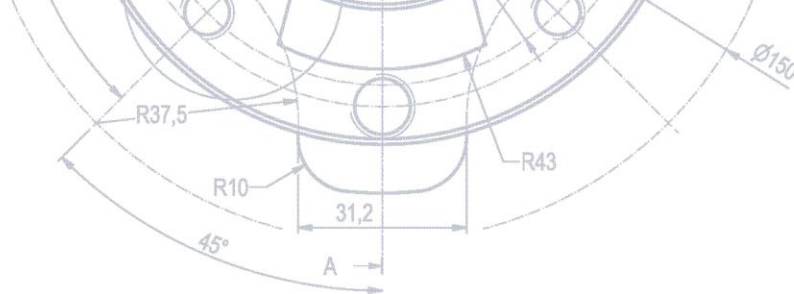

www.zlkl.cz

BASIC FACTS

Core business

- Low & medium volume machining; customized machining

Certificates

- ISO 9001, ISO 14001, ISO 45001

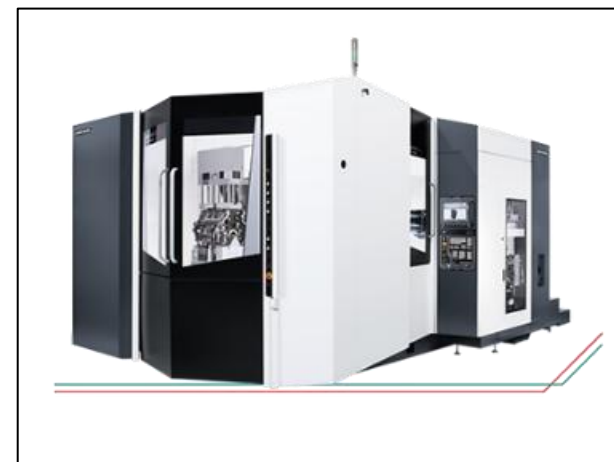

Our strategic suppliers of technology:



DMG MORI



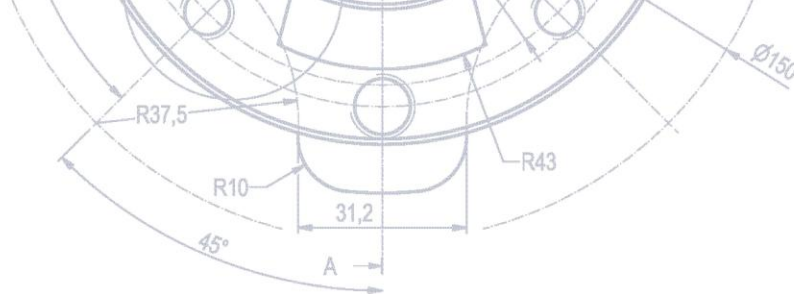

www.zlkl.cz

INTRODUCTION

Services

- Technology process design
- Prototypes production, process optimization
- Mass production, customized production
- Turning, Milling, Drilling

Materials & Products

- Die castings, Cast iron, Forgings
- Stainless steel, copper
- Electrical industry
- Industrial automation
- ATEX environment
- Hydraulic units

Technology

- Vertical pick-up lathes up to Ø 450 mm
- Vertical lathes up to Ø 800 mm
- Horizontal milling up to 630x630 mm
- Vertical milling machines up to 1 000x500x500 mm
- In-house Tool shop, CAD/CAM application

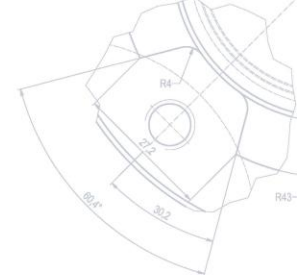
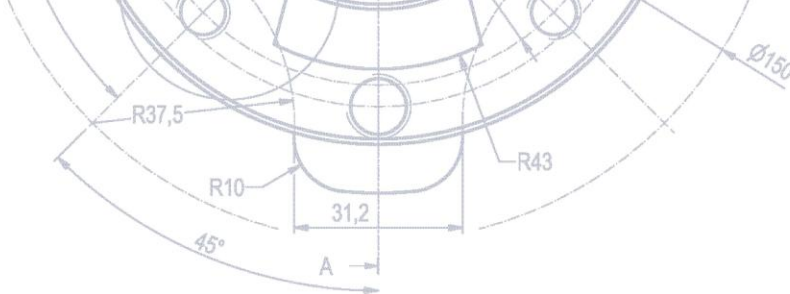

www.zlkl.cz

TECHNOLOGY AVAILABLE



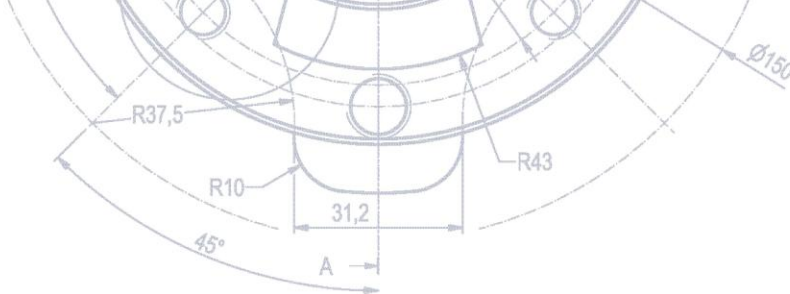

www.zlkl.cz

PRODUCTS EXAMPLES

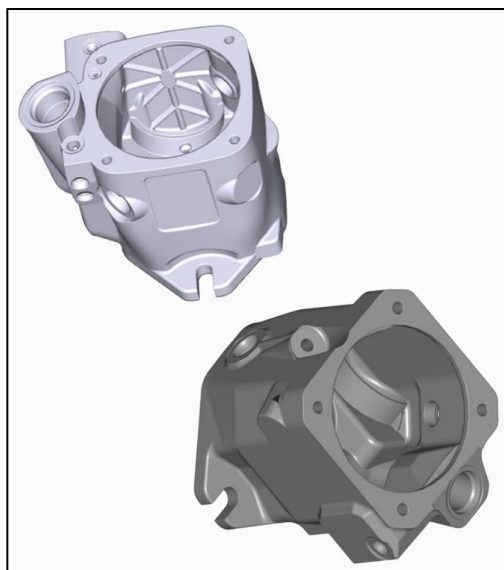
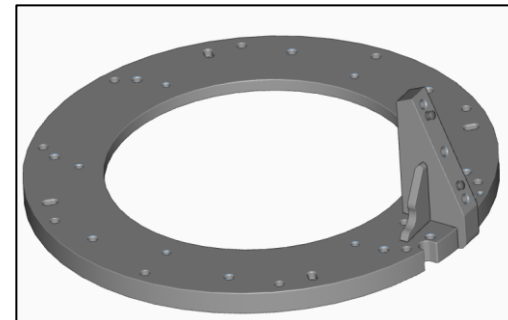
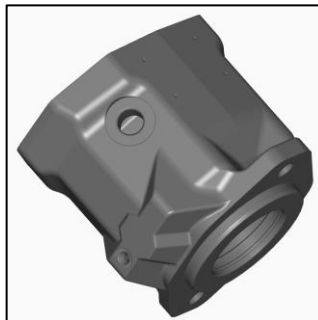

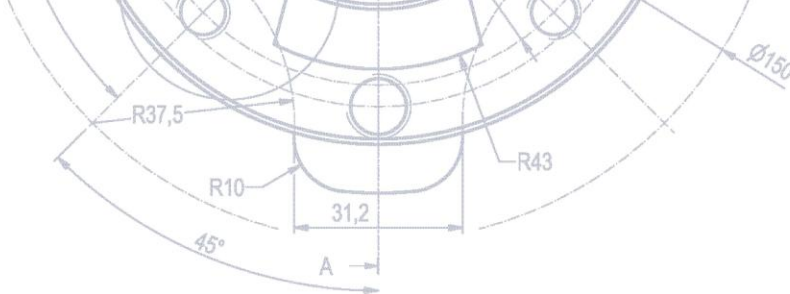

www.zlkl.cz

LATEST REALIZED INVESTMENTS

Five axis milling centres GROB

- Grob G350
- Grob G550



Zeiss Prismo

- Rotary table and swivel probe on active scanning head



EMAG VL 8

- Two brand new vertical pick-up lathes



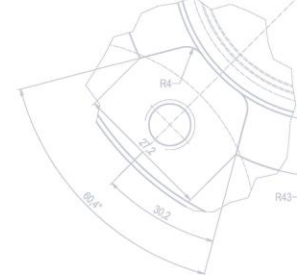
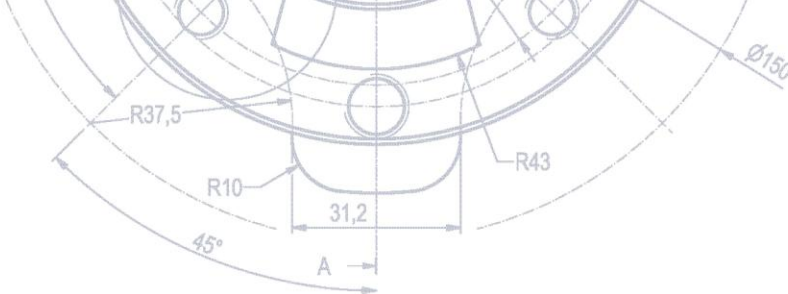

www.zlkl.cz

SHOPFLOOR TOUR

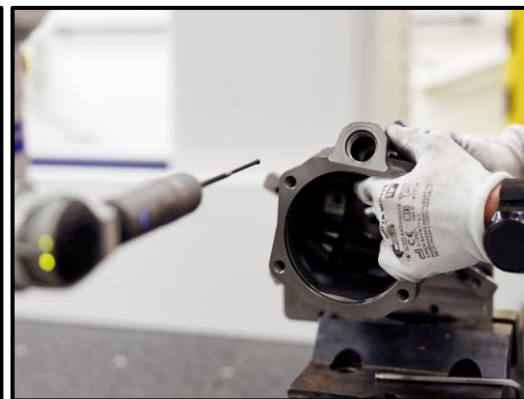

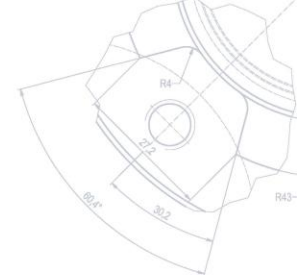
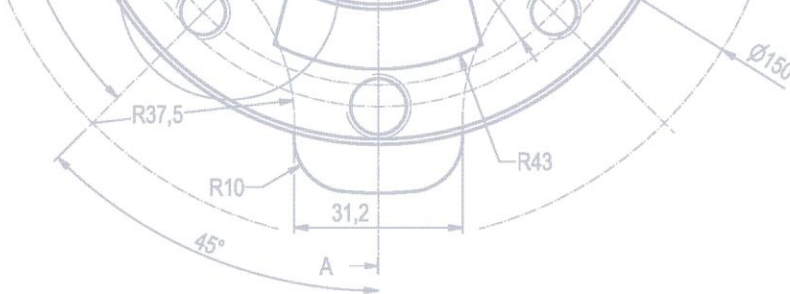

www.zlkl.cz

CUSTOMERS



BANG & OLUFSEN



Division Auto

Senior manager: František Hrdlička

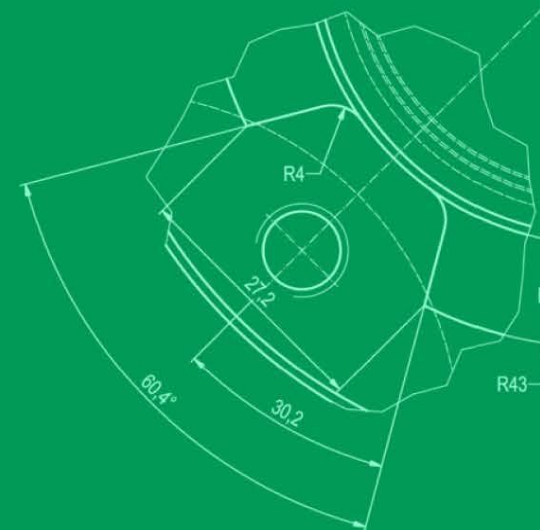

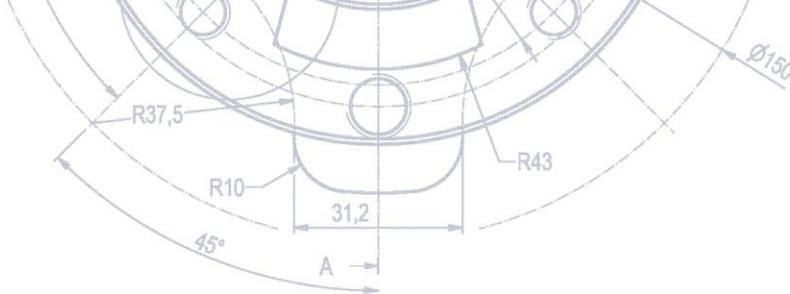

www.zlkl.cz

BASIC FACTS

Core business

- High volume machining, fine cleaning

Certificates

- ISO 9001, ISO 14001, ISO 45001
IATF 16949



Our strategic suppliers of technology:



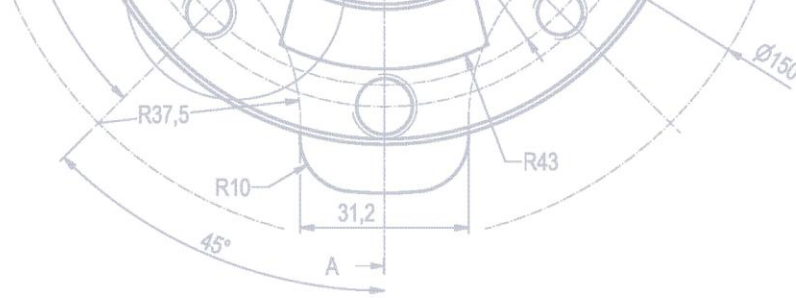

CAPABILITIES & PRINCIPLES

Engineering and design

- Cooperation with customer's R&D on a product design
- Process development focused on costs per piece
- Own tooling shop, CAD/CAM application

Quality

- Awareness of APQP
- Awareness of the approval process
 - PPAP, PPF
- Modern equipment
 - CMM Zeiss machines, optical scanning, contourgraph, roughness meters
- CAQ software PalStat
 - 8D reports, Control Plan, FlowChart, SPC, MSA, FMEA, sampling process & project management

Production

- Using of Lean standards (5S, TPM, OEE)
- Vertical turning, horizontal milling, fine cleaning
- Modern Equipment (e.g. Emag, DMG, GROB)
- Focus on automation



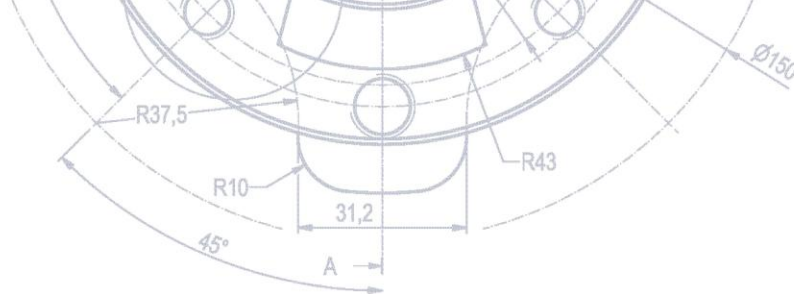

www.zlkl.cz

CUSTOMERS



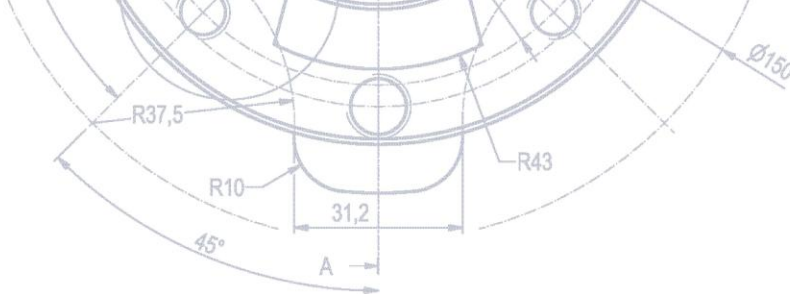

www.zlkl.cz

PRODUCTS EXAMPLES

Application

- Powertrain systems of PKW & LKW
 - Combustion engines & hybrids
 - Mercedes Benz 9G-Tronic & 7G-Tronic transmission
 - Torque Convertors (PKW), clutches, injection system
 - Mechanical covers for Electric batteries (EV cars), headlights and electronics

Customers

- Daimler Trucks, Erdrich Umformtechnik, Ljunghall, Forvia Hella

Product examples

- Turning components up to 400 mm from deep-drawn and formed stampings, aluminium die casting and cast iron
- Fine-cleaned parts for Electronics in passenger cars

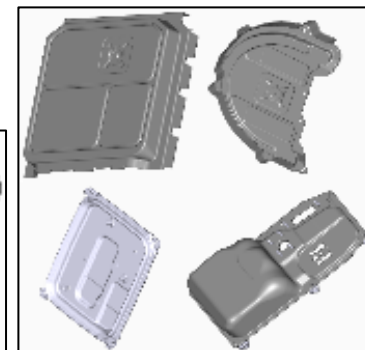
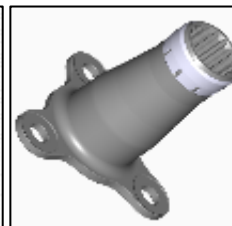
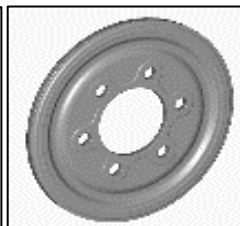
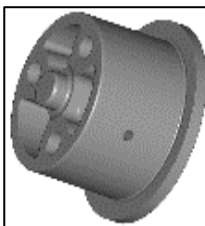
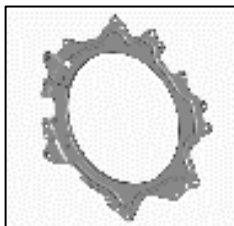
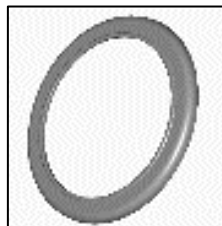

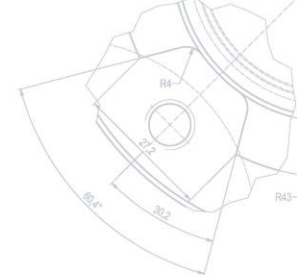
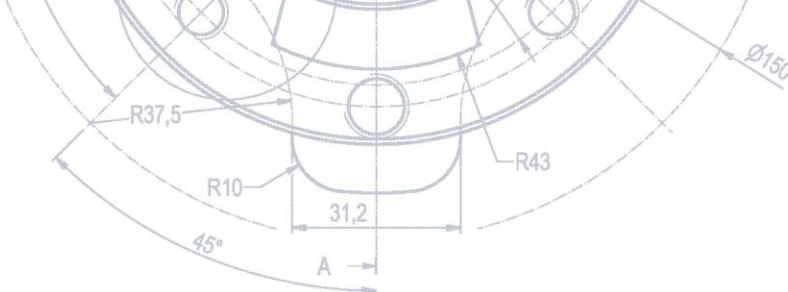

www.zlkl.cz

SHOPFLOOR TOUR

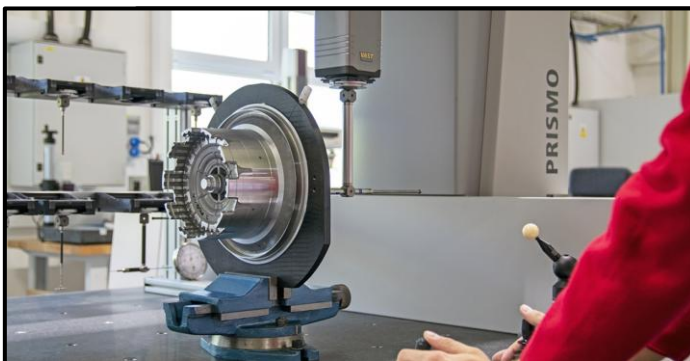

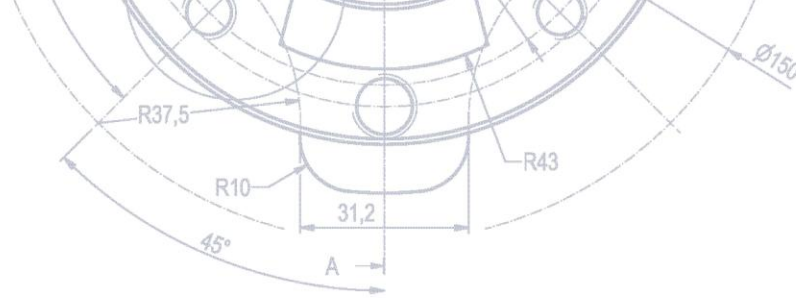

www.zlkl.cz

LATEST REALIZED INVESTMENTS

Five axis milling centre GROB

- Grob G350

Zeiss Duramax

- Two separate CMM for shop floor measurements

EMAG VL3 Duo

- Multi-Spindle Machines for High-Productive Manufacturing

Fully automatized Production cell (parallel line)

- EMAG VL2
- EMAG VL3 Duo
- DMC Laser marking with evaluation
- Fully automatized measuring station from Marposs
- Washing machine Summa

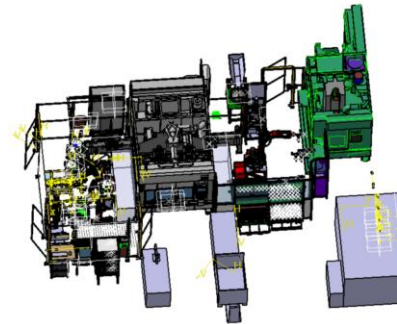

New Machining Division

MEZ 319 - Mohelnice

Leaders: František Hrdlička & Ivo Nemrava

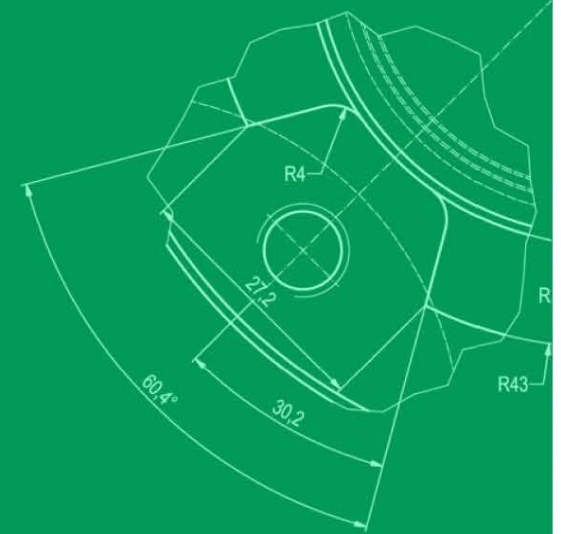

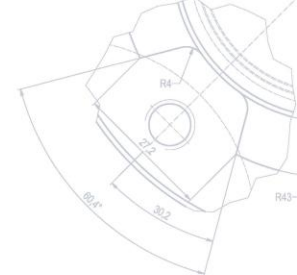
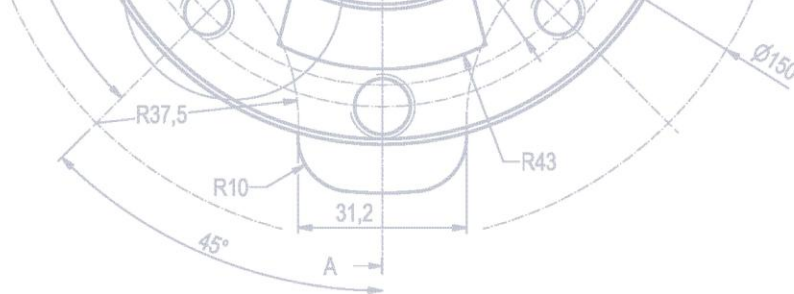

www.zlkl.cz

BASIC FACTS

Core business

- Steel bars production
 - Turning, Milling, Washing
- Customized machining

Certificates

- ISO 9001, ISO 14001, ISO 45001

Our strategic suppliers of technology:



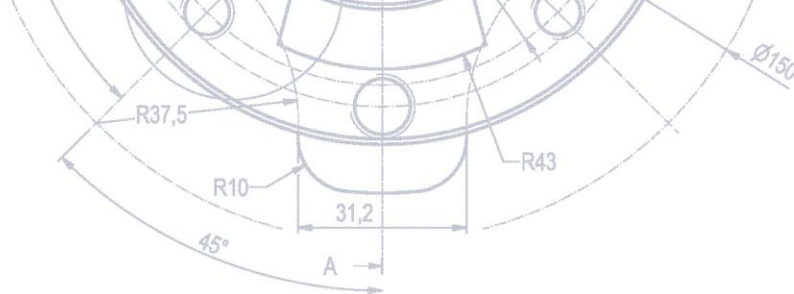

www.zlkl.cz

INTRODUCTION

Services

- Prototypes production, process optimization
- Mass production, customized production
- Turning, Milling, Drilling, Washing

Technology

- Vertical pick-up lathes
- Vertical lathes up
- Horizontal milling
- Water based washing machine

Materials & Products

- Steel bars, castings, stainless steel
- Electrical industry
- Hydraulic units

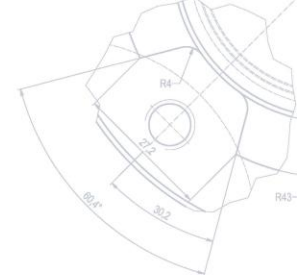
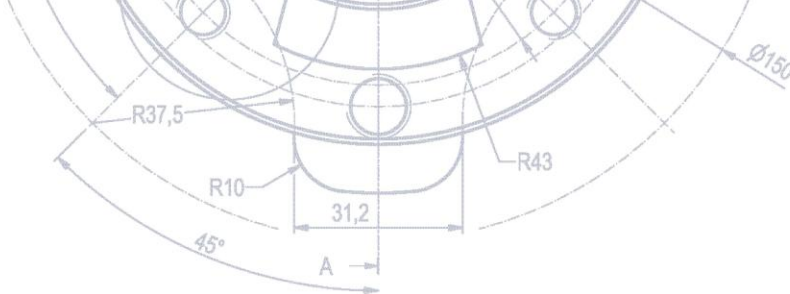

www.zlkl.cz

TECHNOLOGY AVAILABLE



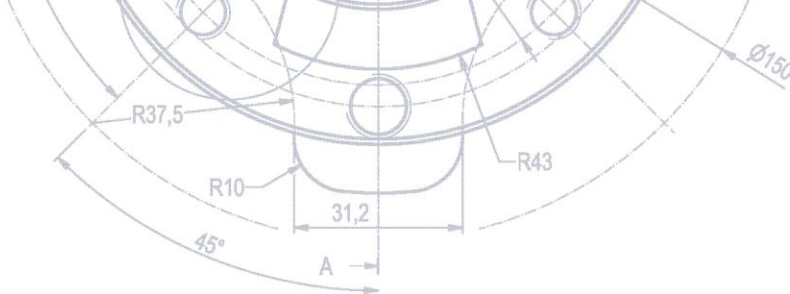

www.zlkl.cz

PRODUCTS EXAMPLES

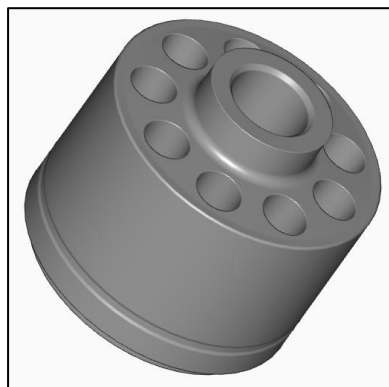
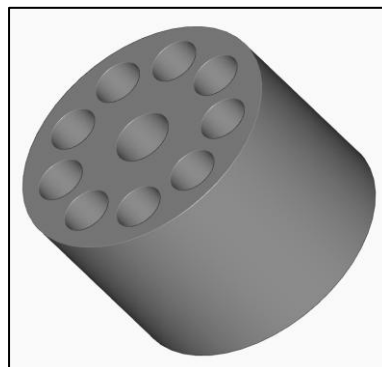
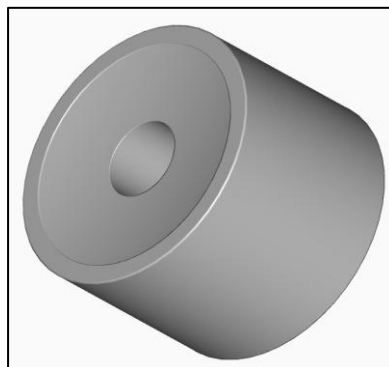

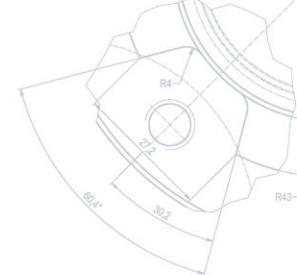
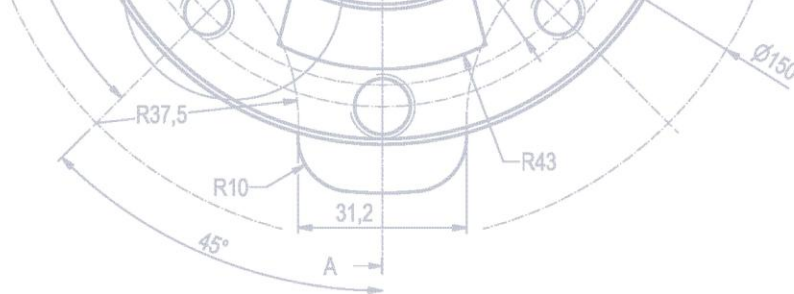

www.zlkl.cz

LATEST REALIZED INVESTMENTS

Zeiss Prismo

- Rotary table and swivel probe on active scanning head



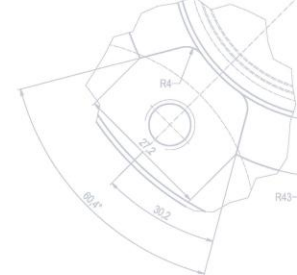
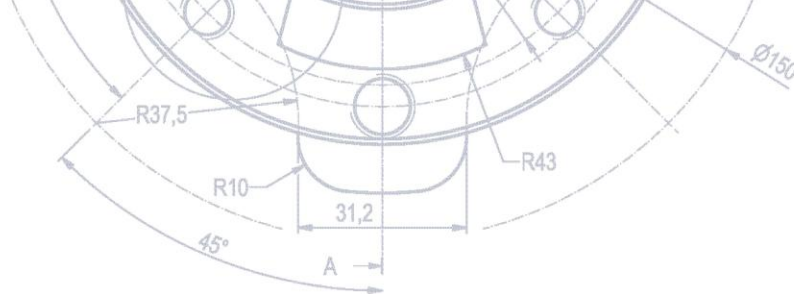

www.zlkl.cz

CUSTOMERS

rexroth
A Bosch Company

SIEMENS

Nidec
All for dreams

EMERSON

Quality Assurance

Senior manager: Matej Re

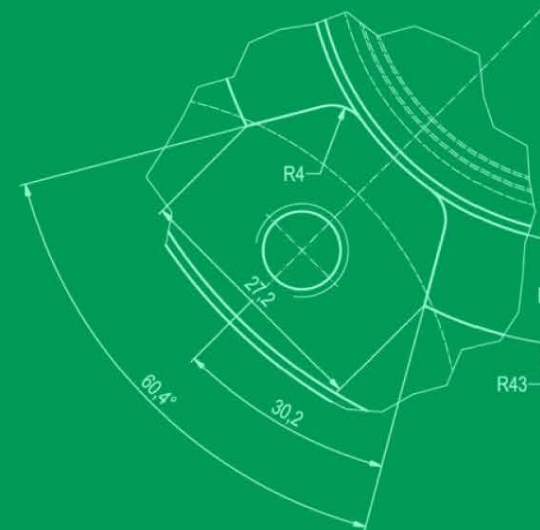

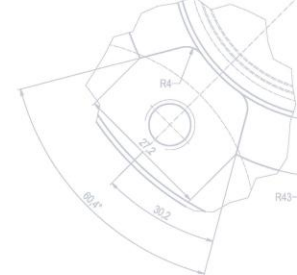
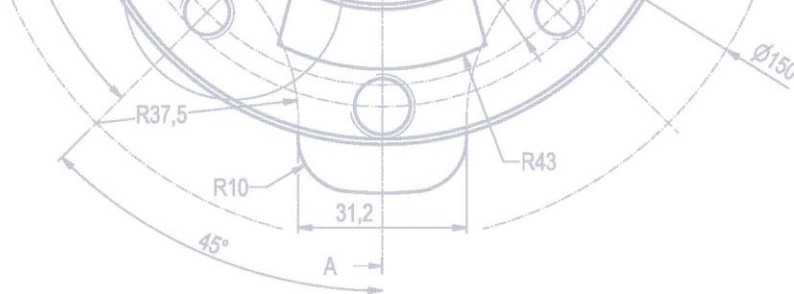

www.zlkl.cz

Organization chart

Quality Department ZLKL

- Metrologist pair of the QA team
- Four different divisions
 - Four separated Quality departments working together
 - Machining - Auto
 - Automotive and high-volume machining
 - Machining - Merger
 - Lower volume and customized machining
 - Machining – MEZ 319
 - Steel bars production
 - Forming – Merger
 - Metal sheet production, welding, powder painting
- Shared contact address: kvalita@zlkl.cz



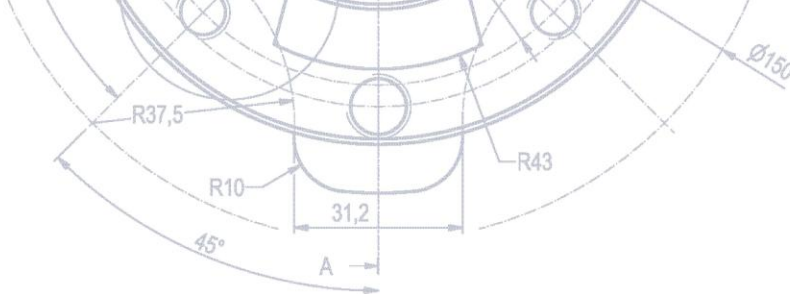

www.zlkl.cz

Measuring Equipment ZLKL Machining Auto

3D Measuring Device

- ZEISS PRISMO & 5 Devices of ZEISS DURAMAX

Contour & Roughness Measuring devices

- Formtracer Avant
- Mitutoyo SV-2100M4

Hardness Tester

- Proceq Equotip 550 Leeb D

Customized Measuring devices

- Marposs automatized measuring units – project dedicated
- DMC marking quality verifier

Standard Gauges

- Calipers, Micrometers, GO/nGO Gauges, Internally Designed and Produced Templates



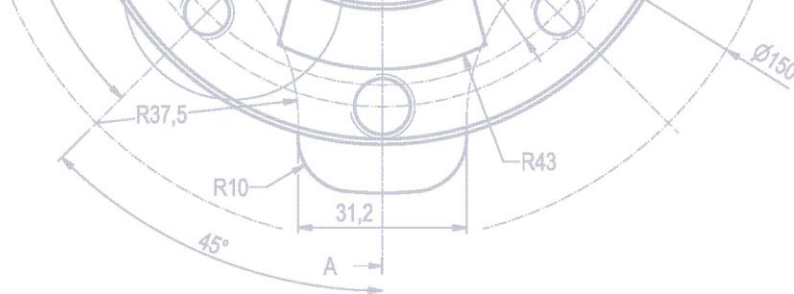

www.zlkl.cz

Measuring Equipment ZLKL Machining Merger

- 3D Measuring Device
 - ZEISS ACCURA & PRISMO
 - 2x ZEISS DURAMAX
- Endoscopy
 - HIPP modular system with cameras
- Contour & Roughness Measuring devices
 - Mitutoyo Contracer
 - Mitutoyo SJ-210
- Standard Gauges
 - Height gauges, Calipers, Micrometers, GO/nGO Gauges



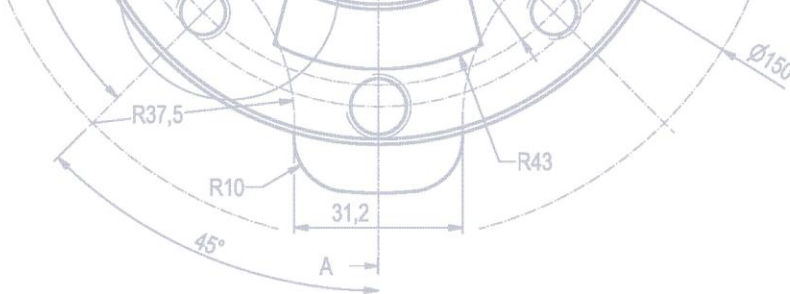

www.zlkl.cz

Measuring Equipment ZLKL Machining MEZ 319

- 3D Measuring Device
 - ZEISS PRISMO
 - 1x ZEISS DURAMAX
- Optical Shaft measuring
 - VICI Vision MTL 850
- Contour & Roughness Measuring devices
 - Formtracer Avant
 - Mitutoyo SJ-210
- Standard Gauges
 - Height gauges, Calipers, Micrometers, GO/nGO Gauges



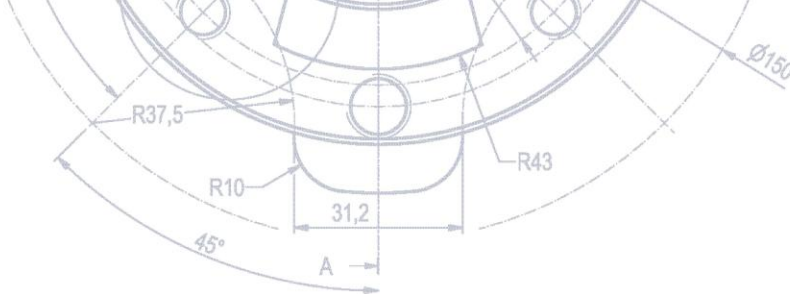

Measuring Equipment ZLKL Forming Merger

3D Scanner

- Atos 5 with GOM software



2D Profile Projector

- Keyence IM-6225

Height Gauges

- Mahr Digimar 817 CLM
- Mitutoyo LH 600 B



Surface inspection

- Cross-cut testing kit Elcometer 107 & 1542
- Various thickness meters
- Gloss meter Elcometer 480



Standard Gauges

- Calipers, Micrometers, GO/nGO Gauges, Internally Designed and Produced Templates



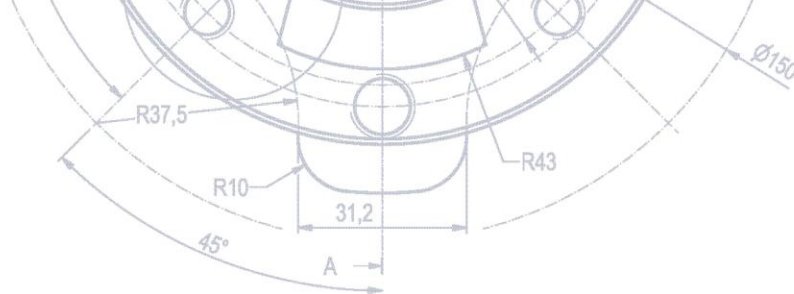

www.zkl.cz

Location and Contact details

Adress: ZLKL, s.r.o.
Moravicanska 581/29
789 83 Lostice
Czech Republic

Contact: info@zkl.cz
+420 778 522 178
<http://www.zkl-cz.com/>

CEO: brazdil@zkl.cz

Sales department: sales@zkl.cz

Quality department: kvalita@zkl.cz

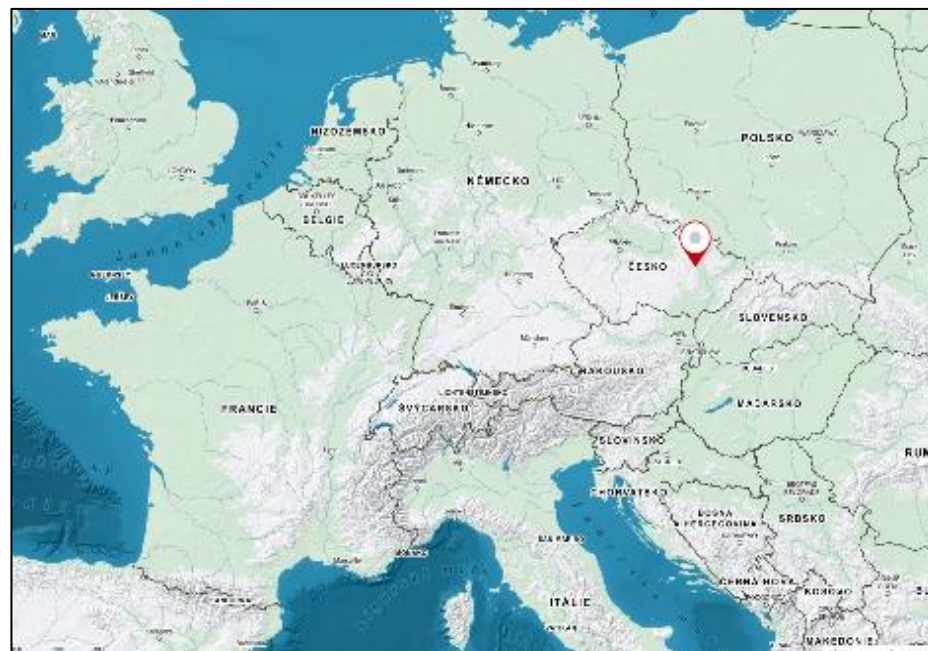

VISION OF ZLKL 2025



VISION OF ZLKL 2026



VISION OF ZLKL 2027

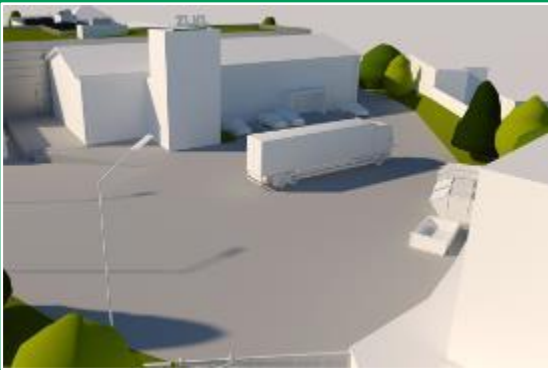

středisko Palackého

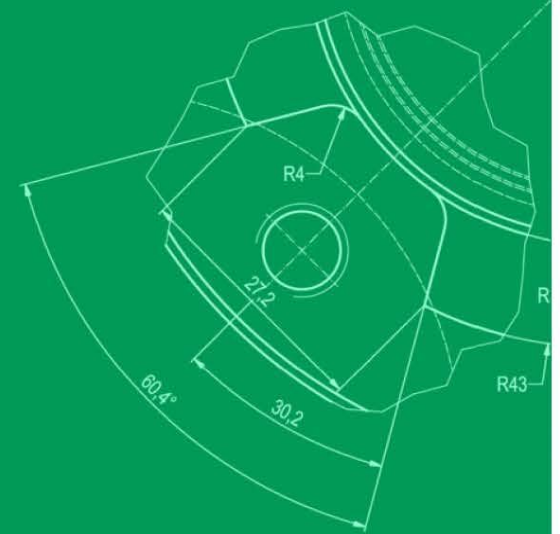

ZLKL, s. r. o.

Thank you

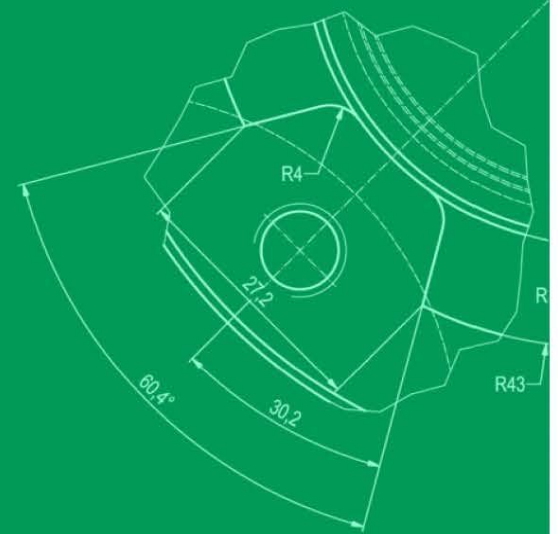
A handwritten signature in white ink, appearing to read 'Beneš', is positioned in the lower right area of the green background.

www.zlkl.cz